

SPECIFICHE TECNICHE  
SPECIFICATIONS

- PRESSIONE NOMINALE RATED PRESSURE	250 bar – 25 MPa (3650 psi)
- PRESSIONE CONSENTITA PERMISSIBLE PRESSURE	280 bar – 28 MPa (4050 psi)
- PORTATA MASSIMA MAX FLOW RATE	40 l/min (10.5 USG p.m.)
- TEMPERATURA MASSIMA MAX WORKING TEMPERATURE	160° C (320 °F)
- MATERIALE MATERIAL	GIRELLO IN PLASTICA ANTIURTO E GUARNIZIONI OR IN VITON. BODY IN SHOCKPROOF PLASTIC AND VITON O-RING

MISURE D'INGOMBRO  
OVERALL DIMENSIONS

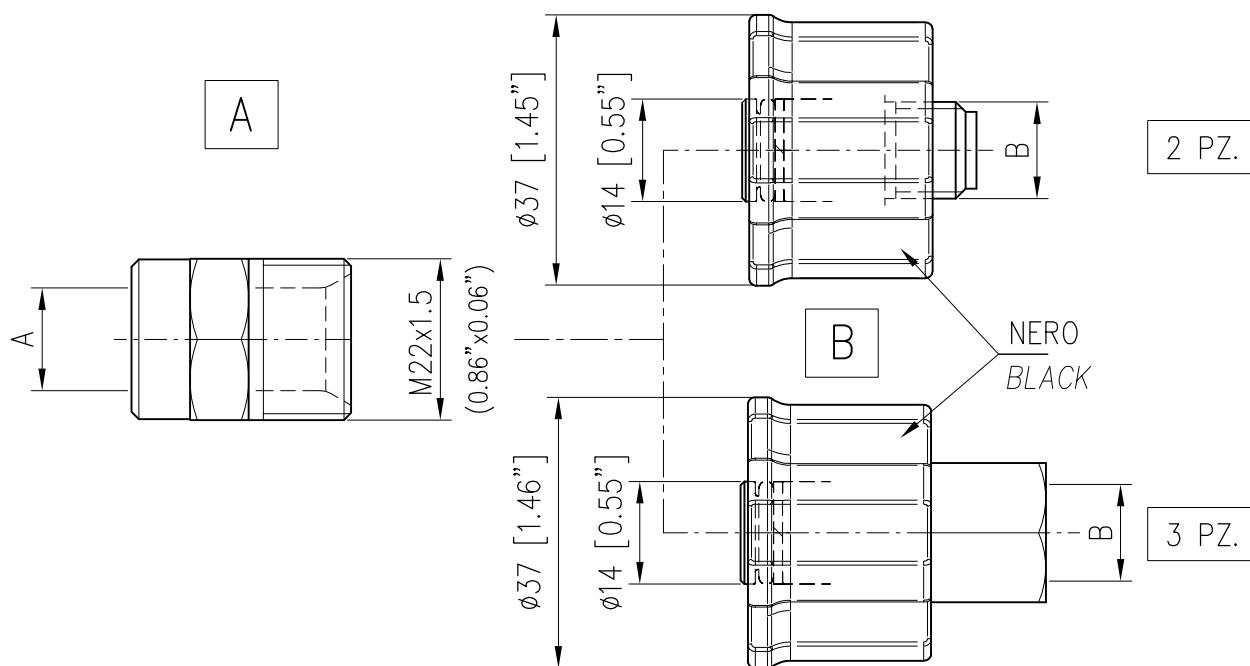

CODICE CODE	A
26.0002.31	G1/4F
26.0005.31	M22x1.5 – Di 14
26.0029.31	G1/8F
26.0030.31	G3/8M
26.0031.31	G3/8F
26.0032.31	G1/2M
26.0033.31	G1/2F
26.0041.31	M21x1.5 – Di 14
26.0051.31	G1/4M

	CODICE CODE	B
2 PZ.	26.0150.05	G1/8F
	26.0150.20	G1/4F
	26.0150.30	G1/4M
3 PZ.	26.0150.40	G3/8M
	26.0250.05	G1/8F
	26.0250.20	G1/4F
	26.0250.30	G1/4M
	26.0250.40	G3/8F
	26.0250.50	G3/8M
	26.0250.60	G1/2F
26.0250.70	G1/2M	

	CODICE CODE	B PERNO GIREVOLE ROTATING PIN
2 PZ.	26.0150.31	G1/4M
	26.0250.21	G1/4F
	26.0250.31	G1/4M
3 PZ.	26.0250.41	G3/8F
	26.0250.51	G3/8M
	26.0250.61	G1/2F
	26.0250.71	G1/2M