

	E T L	EQUIPAGGIAMENTI TECNICI LAVAGGIO	ATTACCO RAPIDO A GHIERA QUICK COUPLING WITH NUT <b>AR1</b> D.15	(I) (GB)	<b>5</b> 01
					22/04/09

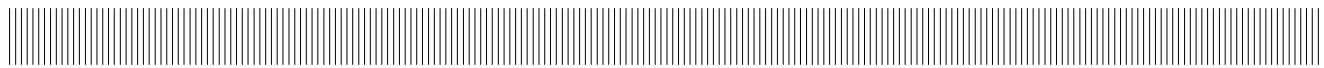

SPECIFICHE TECNICHE  
SPECIFICATIONS

- PRESSIONE NOMINALE RATED PRESSURE	250 bar – 25 MPa (3650 psi)
- PRESSIONE CONSENTITA PERMISSIBLE PRESSURE	280 bar – 28 MPa (4050 psi)
- PORTATA MASSIMA MAX FLOW RATE	40 l/min (10.5 USG p.m.)
- TEMPERATURA MASSIMA MAX WORKING TEMPERATURE	160° C (320 °F)
- MATERIALE MATERIAL	GIRELLO IN PLASTICA ANTIURTO E GUARNIZIONI OR IN VITON. BODY IN SHOCKPROOF PLASTIC AND VITON O-RING

MISURE D'INGOMBRO  
OVERALL DIMENSIONS

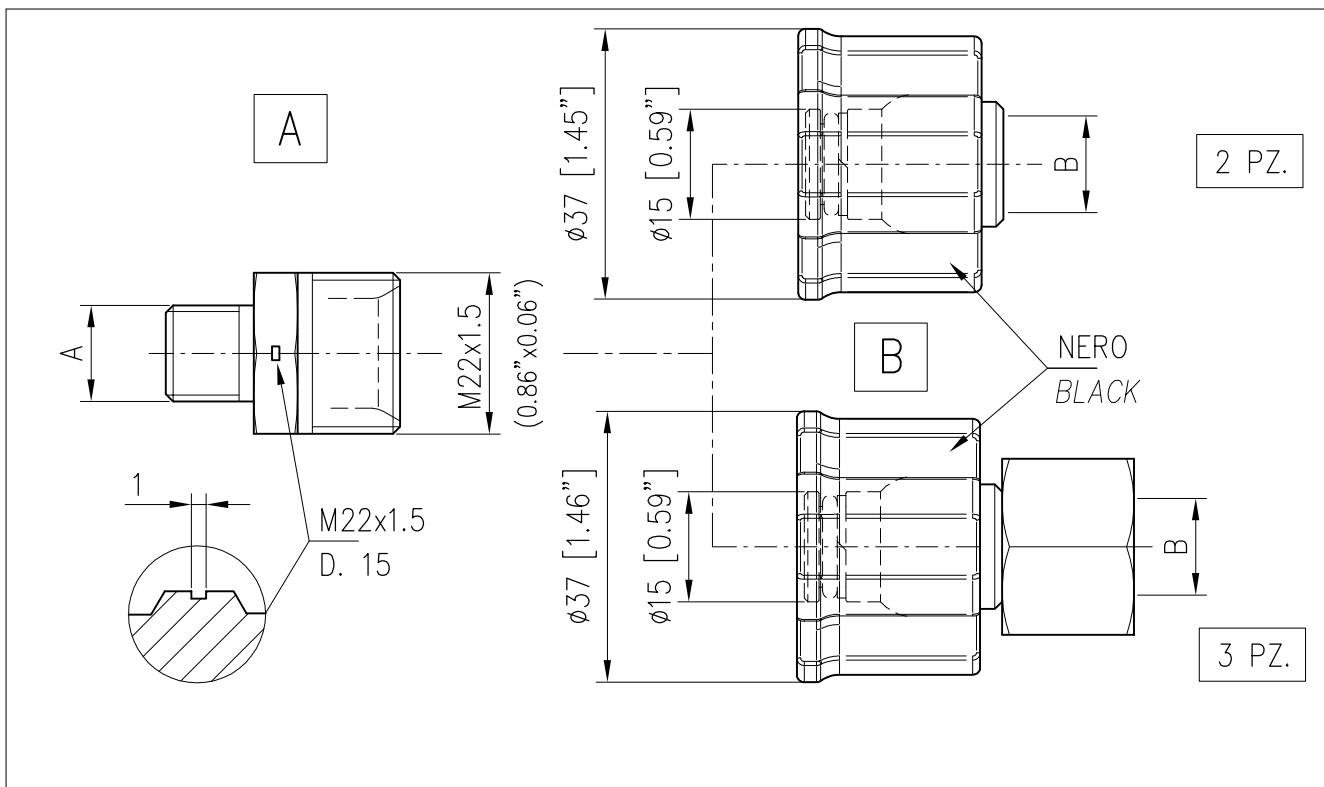

CODICE CODE	A
26.0085.31	G1/4M

	CODICE CODE	B
2 PZ.	26.9152.98	G1/4F
3 PZ.	26.0281.00	M22x1.5 – Di 14
	26.0281.40	G3/8F
	26.0281.50	G3/8M